

The product is powered by electricity. In order to avoid burns, fire and electric shock and make sure the safe and correct use of the system and maintain the longevity of the overall construction and the built-in electronics, please read the instructions carefully.

## WARNING

- The mount will stop when the Apple TV or too many cables are added.
- The child safety kicks in and movement is stopped.
- This appliance can be used by children aged from 8 years and above if they have been given supervision or instruction concerning use of the appliance in a safe way and understand the hazards involved. Children shall not play with the appliance. Cleaning and user maintenance shall not be made by children without supervision.
- Persons with reduced physical, sensory or mental capabilities or lack of experience and knowledge must not use the appliance, unless they're under supervision, understand the hazards involved or they have been thoroughly instructed in the use of the apparatus by a person who is responsible for the safety of these persons.
- Don't leave the cords or plug unorganized in order to prevent tripping hazards.
- Any attempts to reconstruct the construction aren't allowed.
- Do not begin the installation until you have read and understood all the instructions and warnings contained in this installation sheet. If you have any questions regarding any of the instructions or warnings, please contact your local distributor.
- This mounting bracket was designed to be installed and utilised ONLY as specified in this manual. Improper installation of this product may cause damage or serious injury.
- This product should only be installed by someone with good mechanical ability who has basic building experience and fully understands this manual.
- Make sure that the supporting surface will safely support the combined weight of the equipment and all attached hardware and components.
- Always use an assistant or mechanical lifting equipment to safely lift and position the equipment.
- Tighten screws firmly, but do not over tighten. Over tightening can cause damage to the items, This greatly reduces their holding power.
- This product is intended for indoor use only. Using this product outdoors could lead to product failure and personal injury.
- Please do not disassemble or change the electronic components of the product without authorization.

## Electrical Safety Instructions

- The appliance is only to be used with the power supply unit provided with the appliance. Alterations of the given power unit aren't allowed.
- Never operate the system with a damaged power supply cord or plug. If any parts is damaged, please contact your service agent of purchase for a replacement.
- Never operate the system if it's in moist environment or its electrical components has contact with liquids.
- Don't clean the product while the power is still connected.
- Don't disassemble or replace components while the power is still connected.
- Unplug the appliance when the system isn't in use, and place the power plug out of children reach.



# Installation manual

## M Motorized Swing Mount X-Large

EAN: 7350105212642

-  Installation Manual
-  تبيّنات لى لى لى
-  Instalační manuál
-  Installationsmanual
-  Installationsanleitung
-  Paigaldusjuhend
-  Οδηγίες εγκατάστασης
-  Manual de instalación
-  Asennusohje
-  Installation Manuel
-  הנקתה יירידה
-  Szerelési kézikönyv
-  Manuale di installazione
-  取り付け説明書
-  설치 설명서
-  Montavimo instrukcija
-  Uzstādīšanas rokasgrāmata
-  Installatie handleiding
-  Installasjonshåndbok
-  Instrukcja instalacji
-  Manual de instalação
-  Manual de instalare
-  Инструкция по установке
-  Inštaláčny manuál
-  Navodila za montažo
-  Installationsmanual
-  Montaj kılavuzu
-  安裝手冊

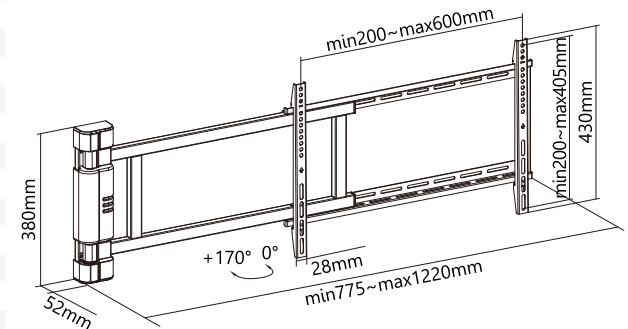



1

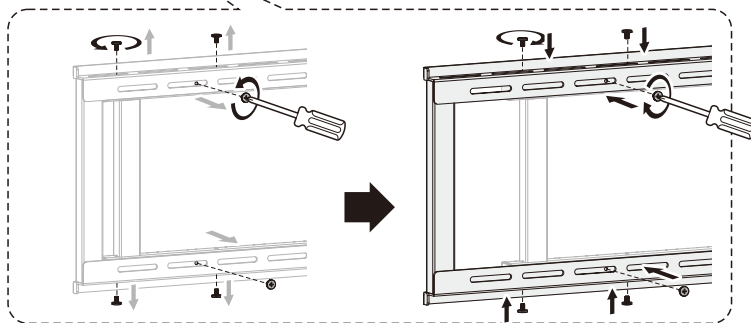
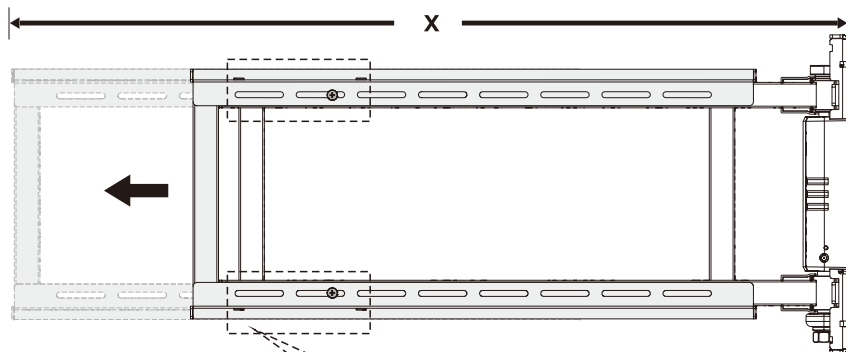
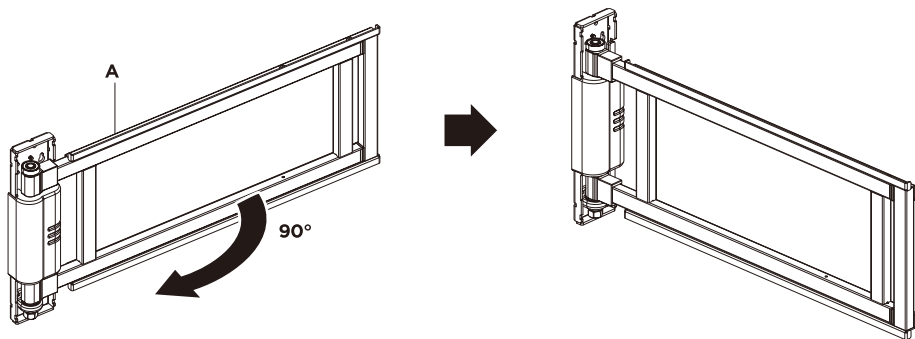

The swing arm needs to be adjusted according to the size of TV.

**X = L/2 + 330(mm)**

X: Length of swing arm  
L: Length of TV

2a

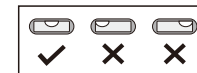

Forward Installation

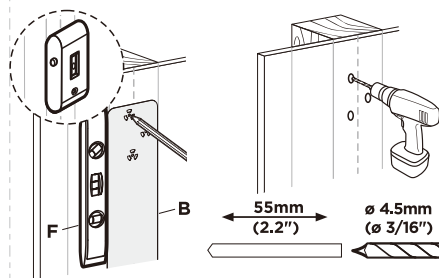

Reverse Installation

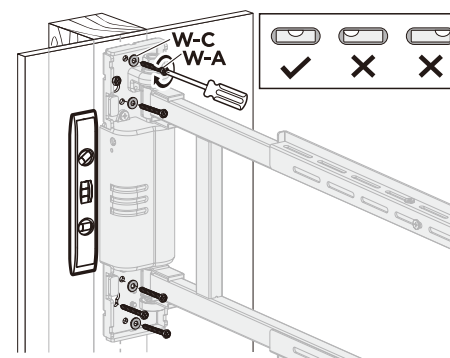
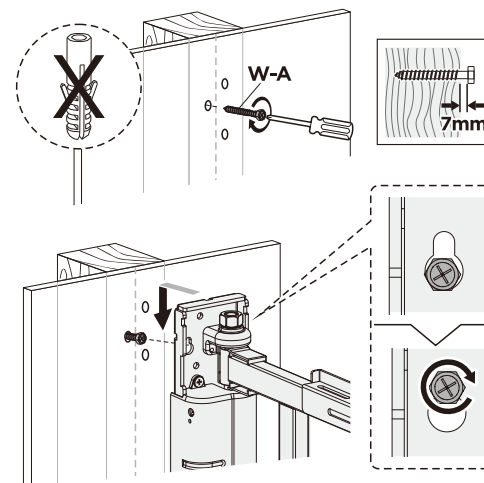
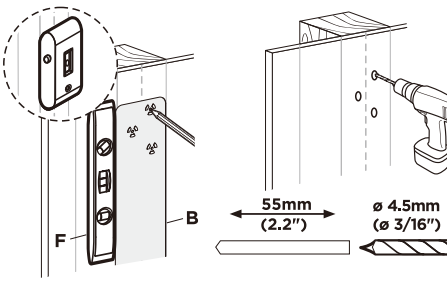

2b

Forward Installation

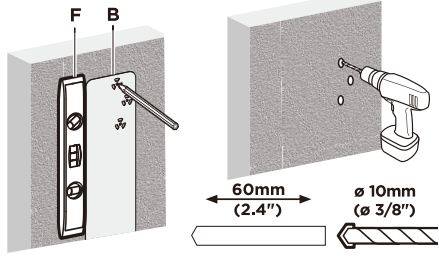

Reverse Installation

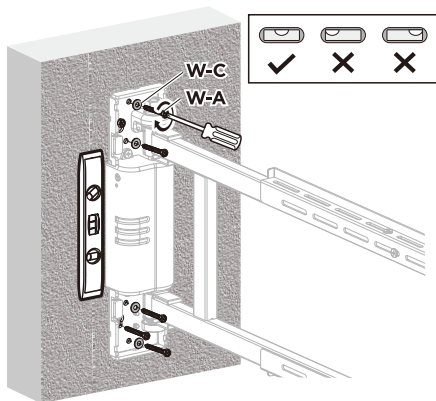
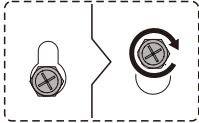
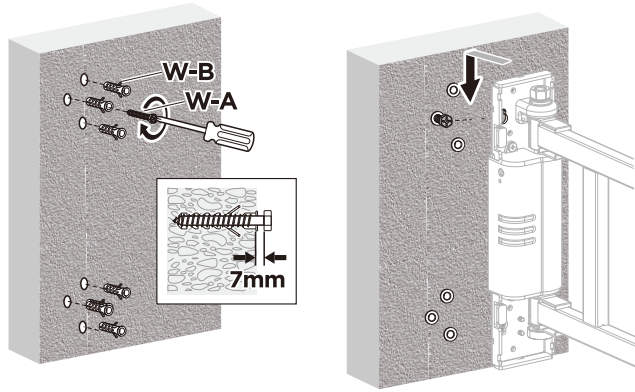
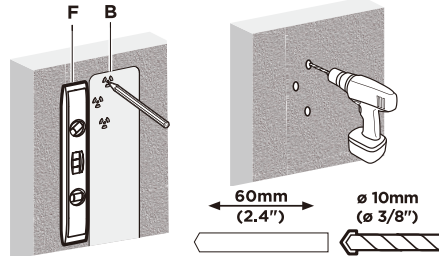

3

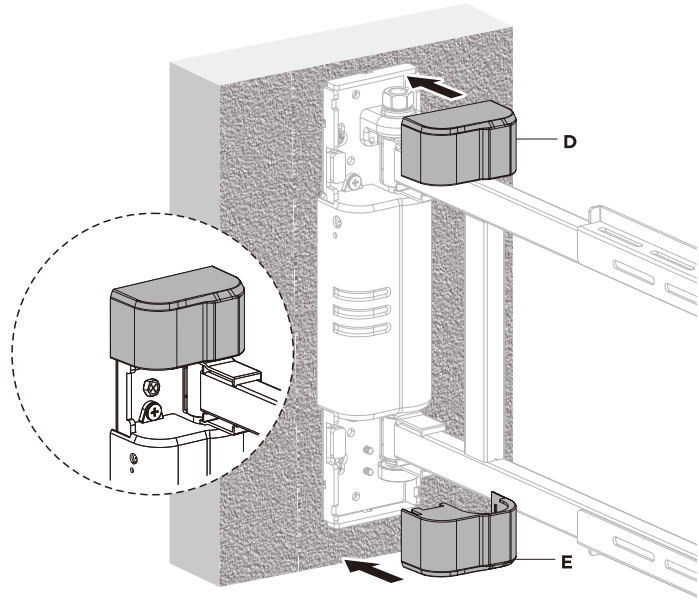

4

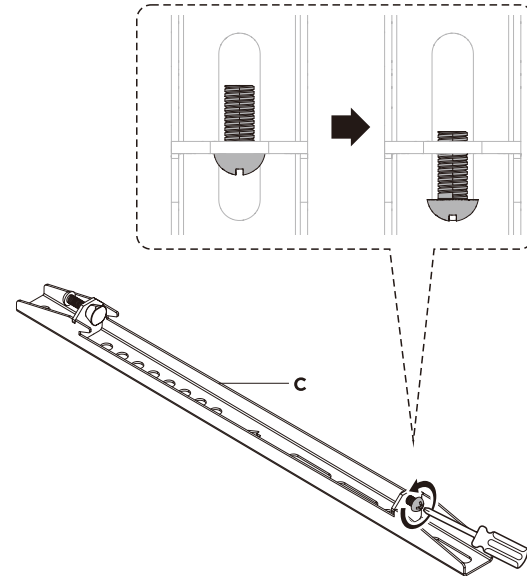

5

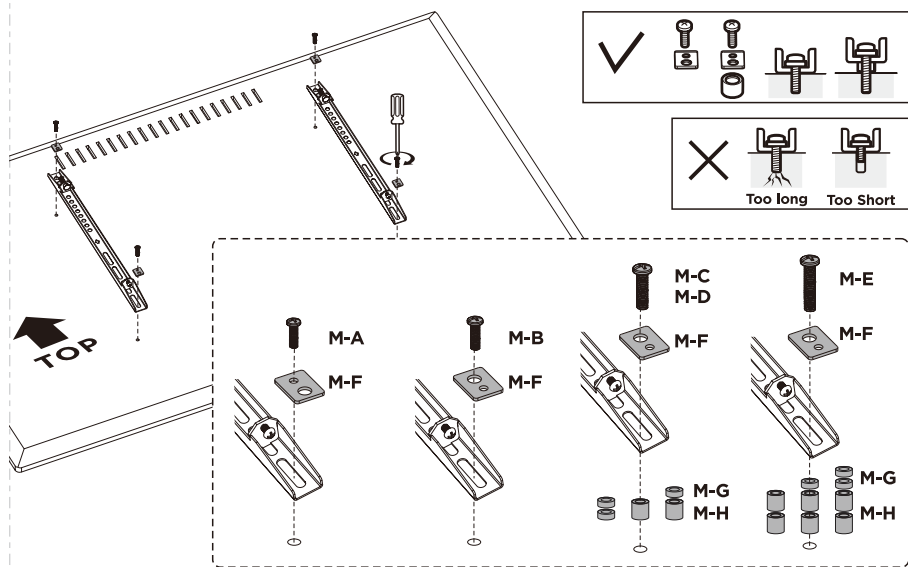

6

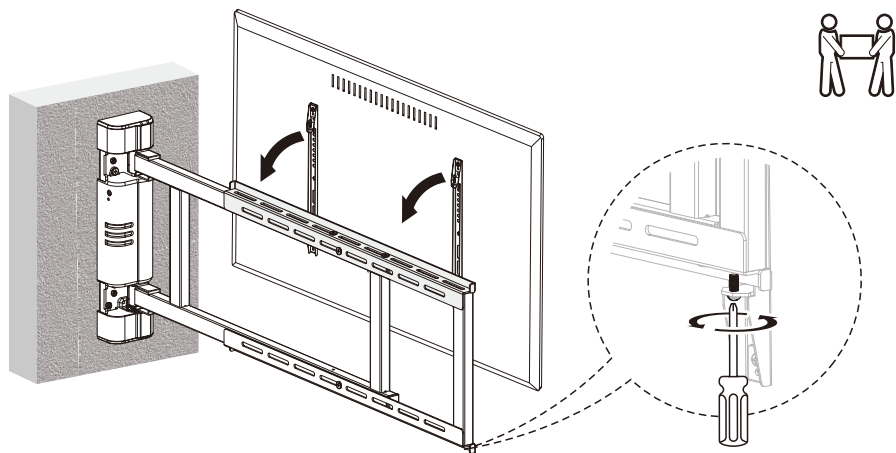

7

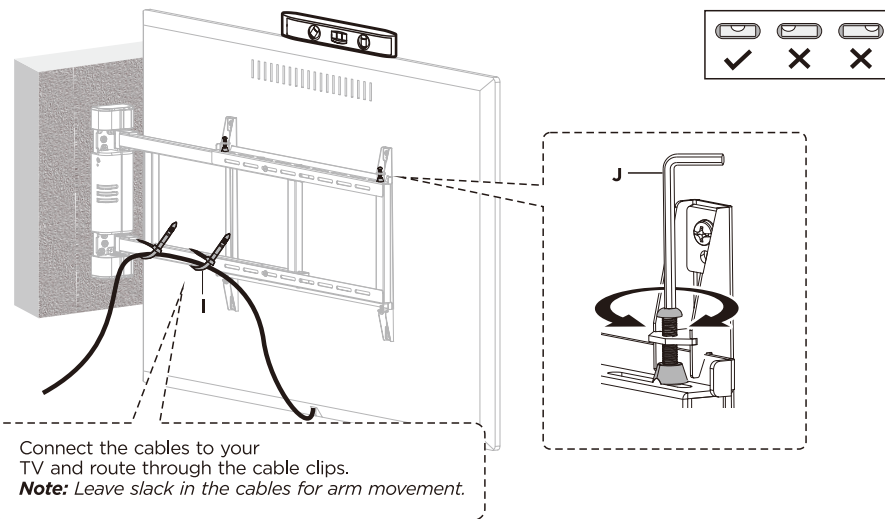

8

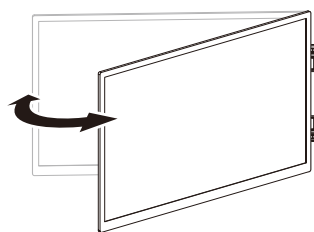
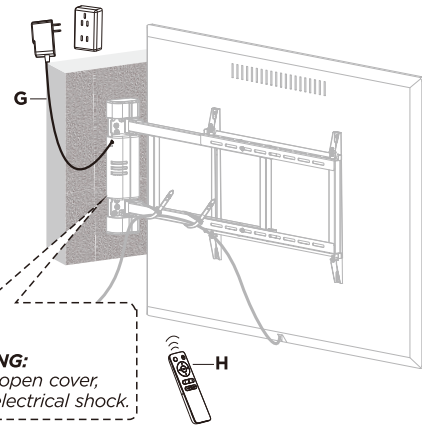

## The Remote Control Operation Instructions

### 1 Pairing the Remote to the Mount

#### STEP 1:

Apply power, and then using a pin or other small item (such as a paperclip) press the code button located on the side of the TV Mount. You will hear a "beep" sound after pressing the code button.

#### STEP 2:

Press , you will hear a series of "beep" sounds for 10 seconds, the remote control is now successfully paired to the TV Mount.

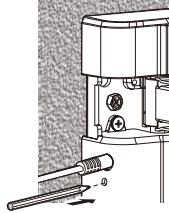

### 2 Resetting the System

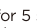
Press and hold  for 5 seconds. The system will start moving automatically, the TV wall mount will move to a 0 degrees position and then stop with a beep sound, which indicates that you successfully reset the system.

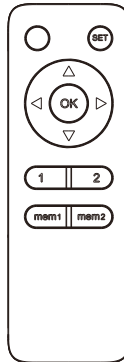

### 4 Storing a TV Mount Position in Memory 2

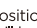
When the TV Mount is in the desired position press and hold  for 2 seconds - you will hear a single "beep" sound indicating the position has been successfully saved in Location 2 of the Remote Control.

### 3 Storing a TV Mount Position in Memory 1

When the TV Mount is in the desired position, press and hold  for 2 seconds - you will hear a single "beep" sound indicating the position has been successfully saved in Location 1 of the Remote Control.

### 5

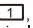
To recall the first saved position, press , the TV wall mount will automatically swivel to the location 1 position.

**6** To recall the second saved position, press , the TV wall mount will automatically swivel to the location 2 position.

**7** Press and release , the TV wall mount will swivel to the left, press  to stop.

**8** Press and release , the TV wall mount will swivel to the right, press  to stop.

**9** The TV wall mount can be installed on two directions (normal or reverse installation). When you find the swivel direction of the TV wall mount is different from the direction button you pressed, set the remote control by following the process: press and hold  for 5 seconds until you hear beep sound, the remote control is now successfully set to operate the mount.

### 10 Increase the swivel range:

The default swivel range of the TV mount is 0°-90°. If you want a swivel range more than 90°, follow the process:

**Step 1:** Adjust the TV wall mount to your desired position manually.

**Step 2:** Press and hold  for 5 seconds until the buzzer sounds one beep. Repeat this step five times until you hear the buzzer make a "beep beep" (2 beeps), this new swivel range is now successfully saved.

**Note:** The max swivel range is 170°.

### Error Indications:

**Over-current Protection:** The buzzer makes a "beep beep" (2 beeps) once

**Sensor indicates the mount is over range:** The buzzer makes a "beep beep" (2 beeps) twice

**Sensor indicates an operating fault:** The buzzer makes a "beep beep" (2 beeps) three times

**Unit senses abnormal power:** The buzzer makes a "beep beep" (2 beeps) four times

## In Front

This guide intends to help you identify and solve the minor problems caused by unusual operation of the electric system of our electric TV mounts. The simple procedures in this manual are easy to follow and capable of solving the most problems happened in everyday use.

## Error Indication

### 1. The Buzzer Constantly Gives Out Alarm Sound: The Error Of Positioning Signal

Reset the system by the instruction manual.



## Remote Control Problems

### 1. Buttons On Remote Control Don't Work. Or The Insensitivity Of Remote Control.

Please check if the batteries have power. if not, please replace the batteries.

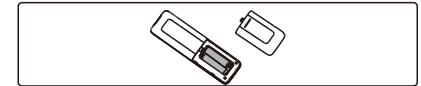

## Abnormal Operation

### 1. The TV Mount Can't Be Adjusted To 0° Or 170°

Please reset the system by following the instruction manual.



### 2. How to reset

Please check the page 9, "Resetting the System"

### 3. TV Mount Stops Suddenly

Please check that cables and other accessories on backside is not creating the TV mount to stop its movement

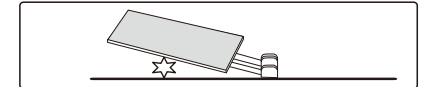

## Test following if the product is not operating properly

Check that all cables are connected, take out plug in. Check that the battery in your remote is new and fresh. Check that the power adapter is properly connected. There should be a buzzer sound and red light indication on the product.

